

MANUFACTURE OF THE PROPRIETARY PARTS SHOWN HERE WITHOUT WRITTEN CONSENT OF HOWMET FASTENING SYSTEMS IS ABSOLUTELY PROHIBITED.

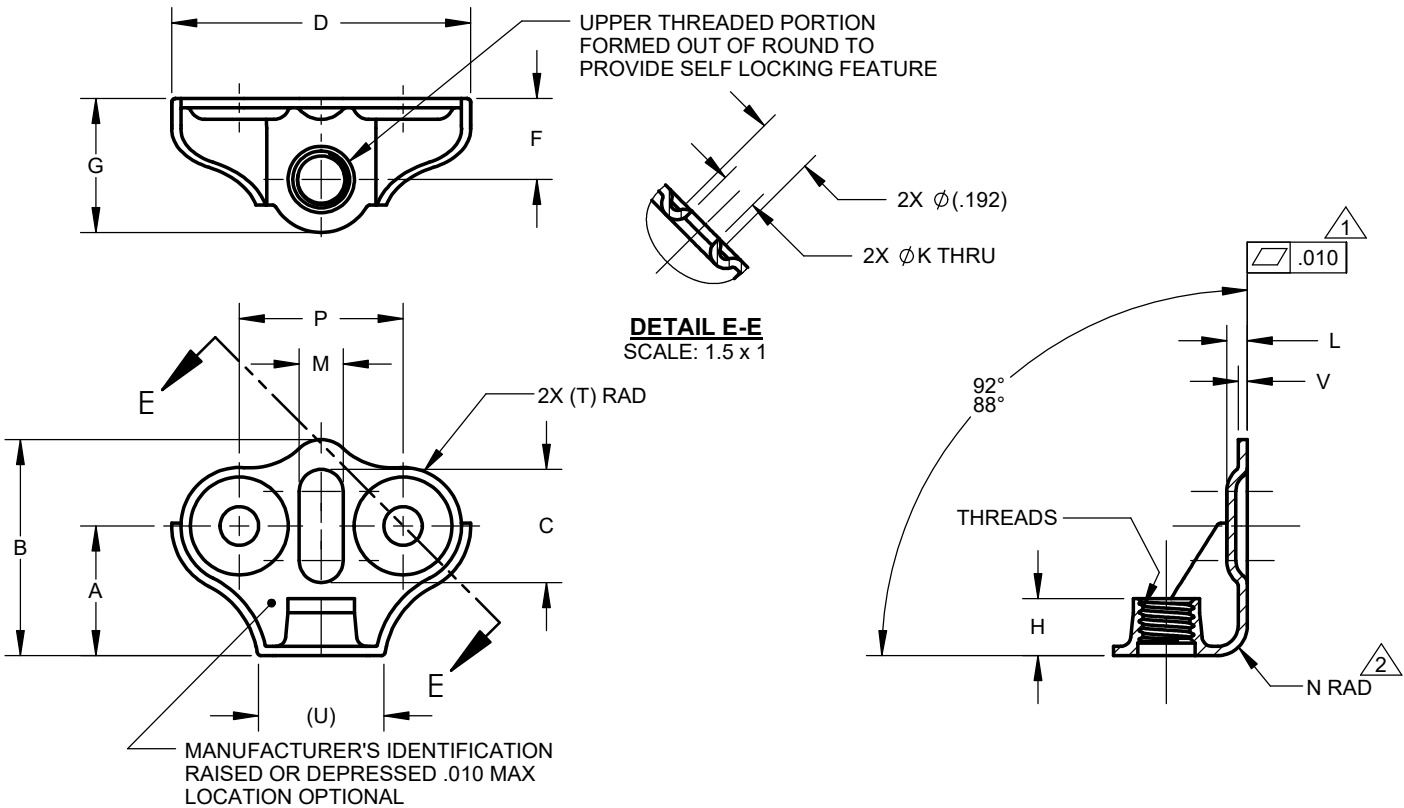

HFS PART NO.	THREADS PER AS8879	A	B	C	D	F	G	H	ϕ K	L	M	N	P	(T)	(U)	V
T8059S832B-	1	.465 .435	.745 .715	.415 .385	1.052	.296 .266	.480 .450	.189 .159	.135 .130	.086 .057	.175 .145	.108 .079	.564 .560	.204	.449	.037 .032
	2	.665 .635	.945 .915	.615 .585												
	3	.865 .835	1.145 1.115	.765 .735												
T8059S1032B-	1	.465 .435	.745 .715	.415 .385	1.023	.296 .266	.480 .450	.215 .185	.135 .130	.086 .057	.175 .145	.108 .079	.564 .560	.204	.449	.037 .032
	2	.665 .635	.945 .915	.615 .585												
	3	.865 .835	1.145 1.115	.765 .735												

MATERIAL: C1050 CARBON STEEL PER AMS5085 (UNS G10500) OR ASTM A684.

HEAT TREAT: Rc 34-41 PER AMS-H-6875.

FINISH: T8059S(*)B-(*):
CADIUM PLATE PER AMS-QQ-P-416, TYPE II, .0003-.0007 THICKNESS PLUS SOLID FILM LUBE PER AS5272, TYPE I.
T8059S(*)B-(*):CPC:
CADIUM PLATE PER AMS-QQ-P-416, TYPE II. NO LUBE

PERFORMANCE: NASM25027.

TEMPERATURE: 450 °F MAX.

NOTES:

1. MOUNTING SURFACE FLATNESS TO BE MEASURED ALONG THE COMMON AXIS OF THE RIVET HOLES. THE MAXIMUM FLATNESS BENEATH ONE RIVET HOLE BOSS TO BE MEASURED WITH A FEELER GAGE WHEN THE OPPOSITE BOSS IS IN CONTACT WITH A FLAT SURFACE.
2. BEND RADIUS TANGENT WITH THREADED BASE SHALL NOT INTERSECT THREADED HOLE.
3. DIMENSIONS APPLY AFTER FINISH, BUT BEFORE LUBRICATION.

THIRD ANGLE PROJECTION

EAR EXPORT CONTROLLED TECHNICAL DATA: DISTRIBUTION LIMITED TO U.S. PERSONS OR THOSE NON-U.S. PERSONS COVERED BY AN APPROPRIATE EXPORT LICENSE OR ALLOWED FOR BY THE APPROPRIATE REGULATIONS, ECCN: EAR99.

APPROVED DATE	07JUN1992
REV. LETTER AND DATE:	C 10JUN2020
CUSTOMER:	

CURRENT DESIGN ACTIVITY:

HOWMET AEROSPACE

Howmet Fastening Systems
800 S State College Boulevard
Fullerton, California, 92831

<http://www.hfs.howmet.com>

TITLE:

**NUT - ANCHOR,
RIGHT ANGLE, STRAIGHT BACK
SELF LOCKING**

UNLESS OTHERWISE SPECIFIED, DIMENSIONS ARE IN INCHES & TO ASME Y14.5-2018 TOLERANCES: DECIMALS = ±.010; ANGLES = ±2°

CAGE CODE: 52828

SALES DRAWING No.

T8059S(*)B-(*)

SHEET 1 OF 1

FILED AS: S_T8059S(B-)