

MANUFACTURE OF THE PROPRIETARY PARTS SHOWN HERE WITHOUT WRITTEN CONSENT OF HOWMET FASTENING SYSTEMS IS ABSOLUTELY PROHIBITED.

THIS DRAWING EMBODIES HOWMET FASTENING SYSTEMS CONFIDENTIAL, PROPRIETARY DESIGN & ALL DESIGN, MANUFACTURING PRODUCTION, USE & SALE RIGHTS REGARDING SAME ARE EXPRESSLY RESERVED.

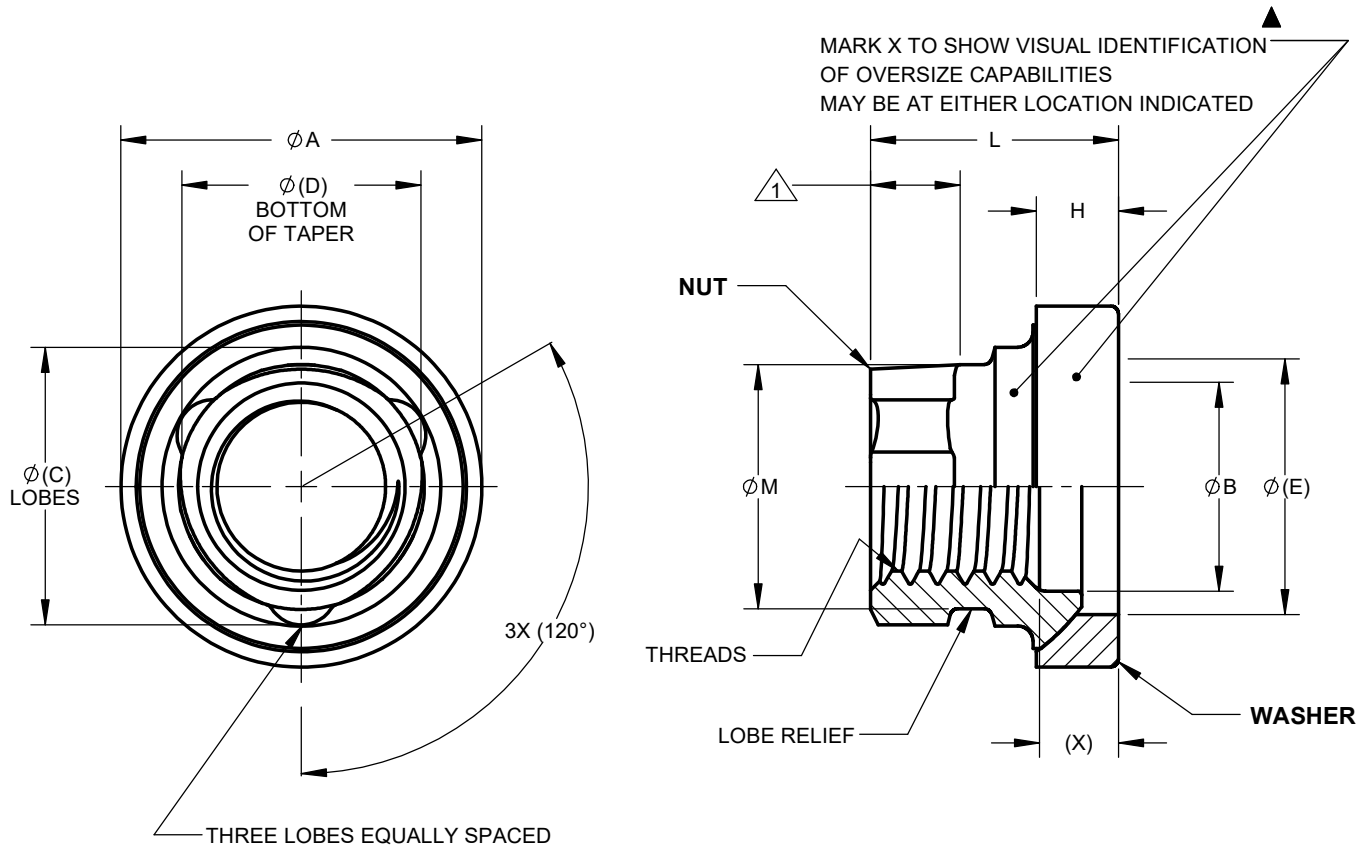

HFS PART NO.	THREADS PER AS8879	ØA	ØB	Ø(C)	Ø(D)	Ø(E)	H	L MAX	ØM MAX	(X)	DRIVE TOOL DASH NO.	AXIAL TENSILE STRENGTH lbf MIN	
EN1382ND(*) EN1382ND(*)X	5	.1640-32UNJC-3B	.365 .355	.173 .167	.247	.219	.232	.095 .085	.275	.219	.095	5	1,940
	6	.1900-32UNJF-3B	.365 .355	.212 .206	.275	.242	.257		.295	.242	.092	6	2,500
	8	.2500-28UNJF-3B	.475 .465	.274 .268	.359	.323	.335	.110 .100	.340	.323	.097	8	4,300
	10	.3125-24UNJF-3B	.620 .610	.338 .330	.435	.390	.419	.130 .120	.435	.390	.104	10	6,300
	12	.3750-24UNJF-3B	.790 .780	.400 .392	.534	.483	.492	.145 .135	.475	.483		12	8,700
	14	.4375-20UNJF-3B	.893 .883	.465 .455	.622	.552	.550	.170 .160	.570	.552	.110	14	11,700
	16	.5000-20UNJF-3B	1.005 .995	.528 .518	.710	.630	.630	.190 .180	.650	.630		16	15,800

6

THIRD ANGLE PROJECTION

EAR EXPORT CONTROLLED TECHNICAL DATA: DISTRIBUTION LIMITED TO U.S. PERSONS OR THOSE NON-U.S. PERSONS COVERED BY AN APPROPRIATE EXPORT LICENSE OR ALLOWED FOR BY THE APPROPRIATE REGULATIONS, ECCN: EAR99.

APPROVED DATE

21DEC1999

REV. LETTER AND DATE:

AC 26JUL2023

CUSTOMER:

CURRENT DESIGN ACTIVITY:



Howmet Fastening Systems
800 S State College Boulevard
Fullerton, California, 92831

<http://www.hfs.howmet.com>

TITLE:

EDDIE-BOLT® 2 NUT, SHEAR
SELF ALIGNING, LIGHTWEIGHT, ASSEMBLY

FOR USE ON STANDARD AND .0156 OVERSIZE PIN

UNLESS OTHERWISE SPECIFIED, DIMENSIONS ARE IN INCHES & TO ASME Y14.5-2018 TOLERANCES: DECIMALS = ±.010; ANGLES = ±2°

CAGE CODE: 15653

SALES DRAWING No.

EN1382ND(*)
EN1382ND(*)X

SHEET 1 OF 2

FILED AS: S_EN1382ND(*)

MANUFACTURE OF THE PROPRIETARY PARTS SHOWN HERE WITHOUT WRITTEN CONSENT OF HOWMET FASTENING SYSTEMS IS ABSOLUTELY PROHIBITED.

THIS DRAWING EMBODIES HOWMET FASTENING SYSTEMS CONFIDENTIAL, PROPRIETARY DESIGN & ALL DESIGN, MANUFACTURING PRODUCTION, USE & SALE RIGHTS REGARDING SAME ARE EXPRESSLY RESERVED.

MATERIAL: NUT:
3AL-2.5V TITANIUM ALLOY PER AMS6940 (UNS R56320).
WASHER:
6AL-4V TITANIUM ALLOY PER AMS4928 OR AMS4967 (UNS R56400).

HEAT TREAT: AMS-H-81200 AND/OR AMS2801.

FINISH: NUT:
COAT OUTSIDE OF NUT, THREADS & C'BORE OPTIONAL, WITH SOLID FILM LUBE PER AS5272, TYPE I, PLUS OPTIONAL CETYL ALCOHOL LUBRICANT.
WASHER:
SOLID FILM LUBE PER AS5272, TYPE I, PLUS OPTIONAL CETYL ALCOHOL LUBRICANT.

PERFORMANCE: ENS1312, EXCEPT AS FOLLOWS:
A) FREE RUNNING TORQUE FOR EN1382ND5 & EN1382NDU5 TO BE 4 in-ozf MAXIMUM.

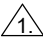
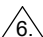
- NOTES:  COLOR IDENTIFICATION:
EN1382ND(*) & EN1382ND(*)X: NUTS ARE IDENTIFIED WITH WHITE PAINT WITHIN LOBE AREA AS SHOWN. ALL THREE LOBES SHALL BE COVERED WITH PAINT ON APPROXIMATELY 95% OF THE LOBE AREA OF EACH PART. OVERSPRAY PERMITTED ON EXTERIOR SURFACES.
EN1382NDU(*) & EN1382NDU(*)X: NO PAINT.
2. MISALIGNMENT: FOR USE ON SLOPED SURFACES UP TO 7° MAXIMUM WHEN MATED WITH APPROPRIATE EDDIE-BOLT® 2 PIN.
 3. DIMENSIONS APPLY PRIOR TO LUBE.
 4. ALL EDDIE-BOLT® 2 NUTS MUST BE INSTALLED USING AN APPROPRIATE DELTA-RAD™ INSTALLATION TOOL.
 5. NUT AND WASHER TO BE ALIGNED WITH LOW BREAKAGE ADHESIVE IN THE ASSEMBLED CONDITION.
-  FOR EN1382ND5X USE EN1382ND6.

EXAMPLE OF PART NUMBER

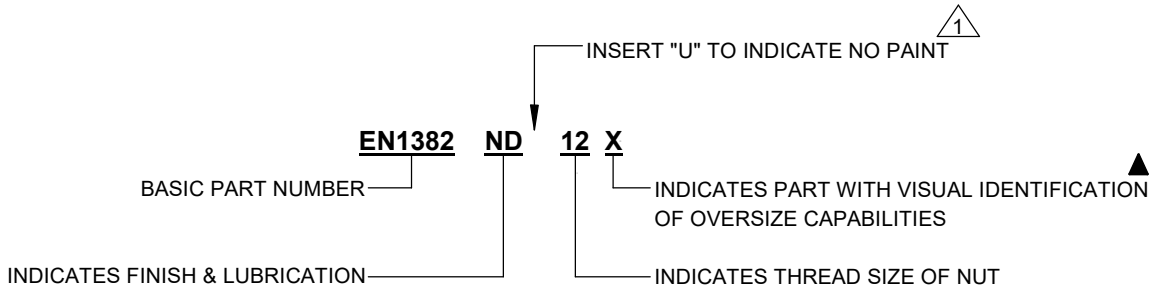

"EDDIE-BOLT" AND "DELTA-RAD" ARE TRADEMARKS OF HOWMET AEROSPACE INC. AND ITS SUBSIDIARIES.
© 2020 HOWMET AEROSPACE INC. ALL RIGHTS RESERVED.

THIRD ANGLE PROJECTION 

EAR EXPORT CONTROLLED TECHNICAL DATA: DISTRIBUTION LIMITED TO U.S. PERSONS OR THOSE NON-U.S. PERSONS COVERED BY AN APPROPRIATE EXPORT LICENSE OR ALLOWED FOR BY THE APPROPRIATE REGULATIONS, ECCN: EAR99.

APPROVED DATE

21DEC1999

REV. LETTER AND DATE:

AC 26JUL2023

CUSTOMER:

CURRENT DESIGN ACTIVITY:



Howmet Fastening Systems
800 S State College Boulevard
Fullerton, California, 92831

<http://www.hfs.howmet.com>

TITLE:

EDDIE-BOLT® 2 NUT, SHEAR
SELF ALIGNING, LIGHTWEIGHT, ASSEMBLY

FOR USE ON STANDARD AND .0156 OVERSIZE PIN

UNLESS OTHERWISE SPECIFIED, DIMENSIONS ARE
IN INCHES & TO ASME Y14.5-2018 TOLERANCES:
DECIMALS = ±.010; ANGLES = ±2°

CAGE CODE: 15653

SALES DRAWING No.

**EN1382ND(*)
EN1382ND(*)X**

SHEET 2 OF 2

FILED AS: S_EN1382ND()