

90° Offset Lever Tools

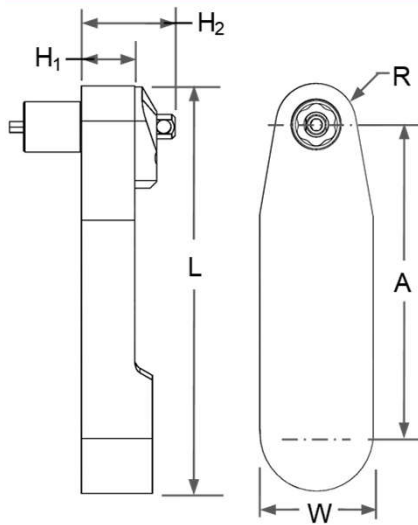

150 in lbs Max.



Model Number	No. of Gears	A	H ₁	H ₂	L	R
CTL5111A	5	2.75 [69.9mm]	.47 [11.9mm]	.61 [15.4mm]	3.68 [93.3mm]	.43 [10.8mm]

This is a very durable tool design for general purpose applications and is designed for use in a flush condition or with extended sockets and hex keys when required.

This gear head has 360° indexing capability.

Table 1	Table 2	Table 3																																										
Frangible Collar	Ext'd.Socket Length	Key Hex Size																																										
Hex Size (Across Flats)																																												
<table><tr><th>Code</th><th>Hex Size</th></tr><tr><td>219</td><td>7/32"</td></tr><tr><td>250</td><td>1/4"</td></tr><tr><td>282</td><td>9/32"</td></tr><tr><td>312</td><td>5/16"</td></tr><tr><td>343</td><td>11/32"</td></tr><tr><td>375</td><td>3/8"</td></tr><tr><td>437</td><td>7/16"</td></tr></table>	Code	Hex Size	219	7/32"	250	1/4"	282	9/32"	312	5/16"	343	11/32"	375	3/8"	437	7/16"	<table><tr><th>Code</th><th>Extension</th></tr><tr><td>A *</td><td>Flush</td></tr><tr><td>C</td><td>0.375"</td></tr><tr><td>D</td><td>0.500"</td></tr><tr><td>E</td><td>0.625"</td></tr><tr><td>F</td><td>0.750"</td></tr><tr><td>G</td><td>1.0"</td></tr><tr><td>J</td><td>2.0"</td></tr></table>	Code	Extension	A *	Flush	C	0.375"	D	0.500"	E	0.625"	F	0.750"	G	1.0"	J	2.0"	<table><tr><th>Code</th><th>Size</th></tr><tr><td>062T</td><td>1/16" Hex Key</td></tr><tr><td>078T</td><td>5/64" Hex Key</td></tr><tr><td>094T</td><td>3/32" Hex Key</td></tr><tr><td>125T</td><td>1/8" Hex Key</td></tr></table>	Code	Size	062T	1/16" Hex Key	078T	5/64" Hex Key	094T	3/32" Hex Key	125T	1/8" Hex Key
Code	Hex Size																																											
219	7/32"																																											
250	1/4"																																											
282	9/32"																																											
312	5/16"																																											
343	11/32"																																											
375	3/8"																																											
437	7/16"																																											
Code	Extension																																											
A *	Flush																																											
C	0.375"																																											
D	0.500"																																											
E	0.625"																																											
F	0.750"																																											
G	1.0"																																											
J	2.0"																																											
Code	Size																																											
062T	1/16" Hex Key																																											
078T	5/64" Hex Key																																											
094T	3/32" Hex Key																																											
125T	1/8" Hex Key																																											

* Flush sockets only available in (.219, .250, .282, .312) hex sizes

24P

* Flush sockets only available in (.219, .250, .282, .312) hex sizes

24P

Example of Complete Tool Model Number:

CTL5111 C 343 A 078

CTL5111
 C
 343
 A
 078
 Hex Key Size (Table 3)
 Extended Socket Length (Table 2)
 Fastener Hex Size (Table 1)
 Ext'd. Drive Shaft (Table 4)
 Tool Model Number