

# Offset Pistol Grip Tools

Tool Torque Range:  
15-140 in-lbs.

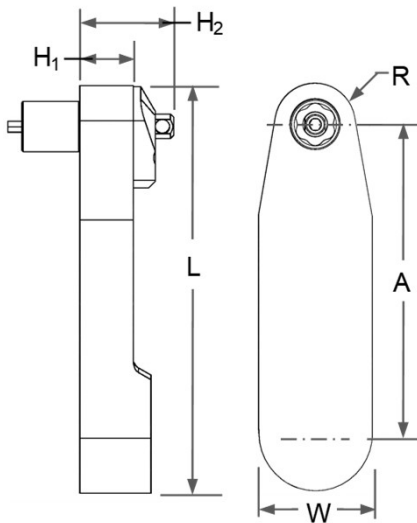

360°  
Index  
Unit

RPM: 230

Sound level : 78dB(A)

Model Number	No. of Gears	A	H <sub>1</sub>	H <sub>2</sub> Ref.	L	W	R
<b>CTL1111</b>	5	2.75" [69.9mm]	.47" [11.9mm]	.72" [18.4mm]	3.68" [93.3mm]	1.0" [25.4mm]	.43" [10.8mm]

Table 1 Frangible Collar Hex Size (Across Flats)		Table 2 Ext'd.Socket Length		Table 3 Key Hex Size		Table 4 Drive Shaft Extended Length		
Code	Hex Size	Code	Extension	Code	Size	Code	Length	Index Unit
219	7/32"	A	Flush	062	1/16" Hex Key	A	-	With
250	1/4"	C	0.375"	078	5/64" Hex Key	B	-	Without
312	5/16"	D	0.500"	094	3/32" Hex Key	C	2.0"	With
343	11/32"	E	0.625"	125T	1/8" Hex Key	D	2.0"	Without
375	3/8"	G	1.0"			G	6.0"	With
437	7/16"	J	2.0"			H	6.0"	Without

24P

Example of Complete Tool Model Number:

**CTL1111 C 343 A 078**

