

90° Offset Lever Tools

520 in-lbs

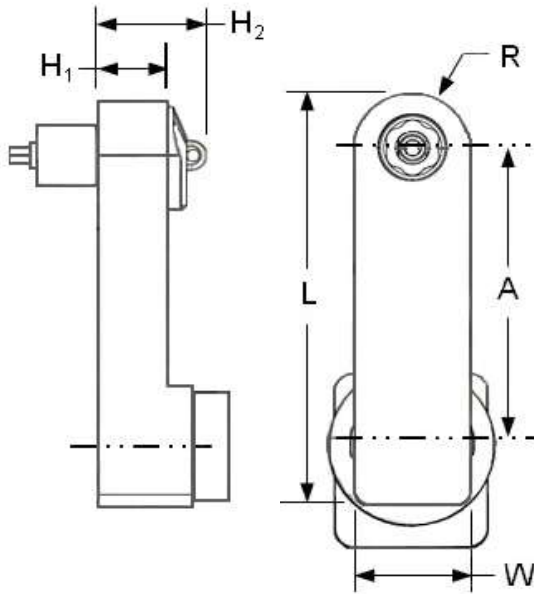

Ref: LTV38N68-13

RPM at Socket: 270

Model Number	No. of Gears	A	H ₁	H ₂	L	R	W
CT5472A	5	3.0" [76.2mm]	.69" [17.5mm]	1.0" [25.4mm]	4.19" [106.4mm]	.56" [14.2mm]	1.12" [28.4mm]

This is a very durable tool design for general purpose applications and is designed for Use in a flush condition or with extended sockets and hex keys when required.

This gear head has 360° indexing capability.

Table 1 Frangible Collar Hex Size (Across Flats)		Table 2 Ext'd.Socket Length		Table 3 Key Hex Size	
Code	Hex Size	Code	Extension	Code	Size
375	3/8"	A	Flush	000	NA
437	7/16"	E	5/8"	125T	1/8"
500	1/2"	G	1.0"	156T	5/32"
562	9/16"	J	2.0"	187T	3/16"
625	5/8"			219T	7/32"
687	11/16"			250T	1/4"

.687 Max A/F Flush Socket Gear

Example of Complete Tool Model Number:

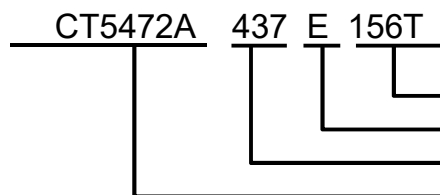

Hex Key Size (Table 3)
Extended Socket Length (Table 2)
Fastener Hex Size (Table 1)
Tool Model Number