

MANUFACTURE OF THE PROPRIETARY PARTS SHOWN HERE WITHOUT WRITTEN CONSENT IS ABSOLUTELY PROHIBITED

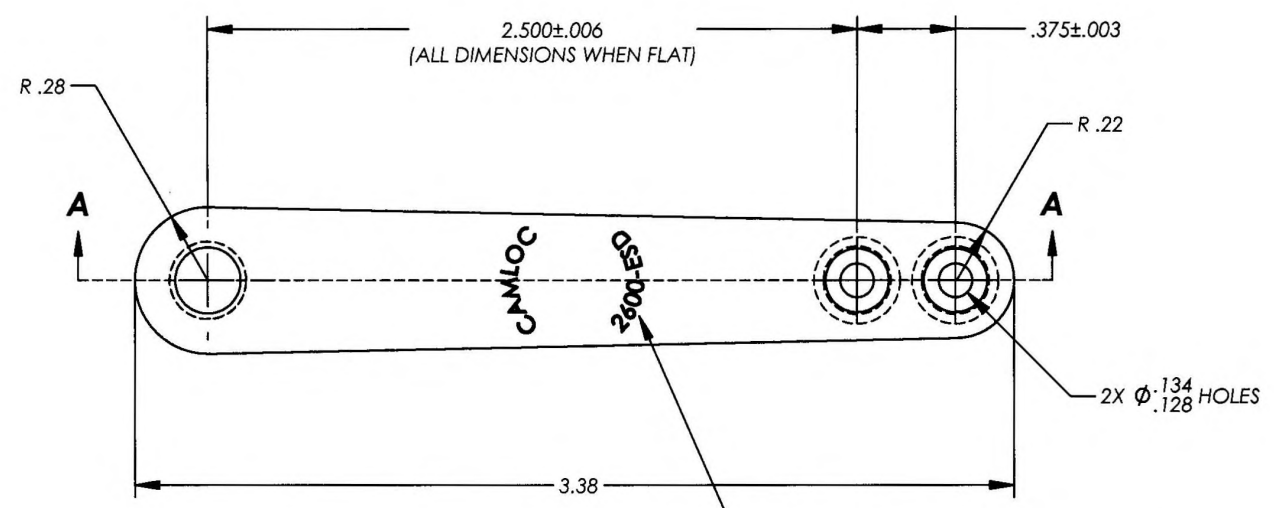

"CAMLOC: & CATALOG PART NO. AS SHOWN RANDOM LOCATION MFG. OPTION: SAME IDENT. ON REVERSE DISC"

THIS DRAWING EMBODIES A CONFIDENTIAL, PROPRIETARY DESIGN & ALL DESIGN, MANUFACTURING PRODUCTION, USE & SALE RIGHTS REGARDING SAME ARE EXPRESSLY RESERVED.

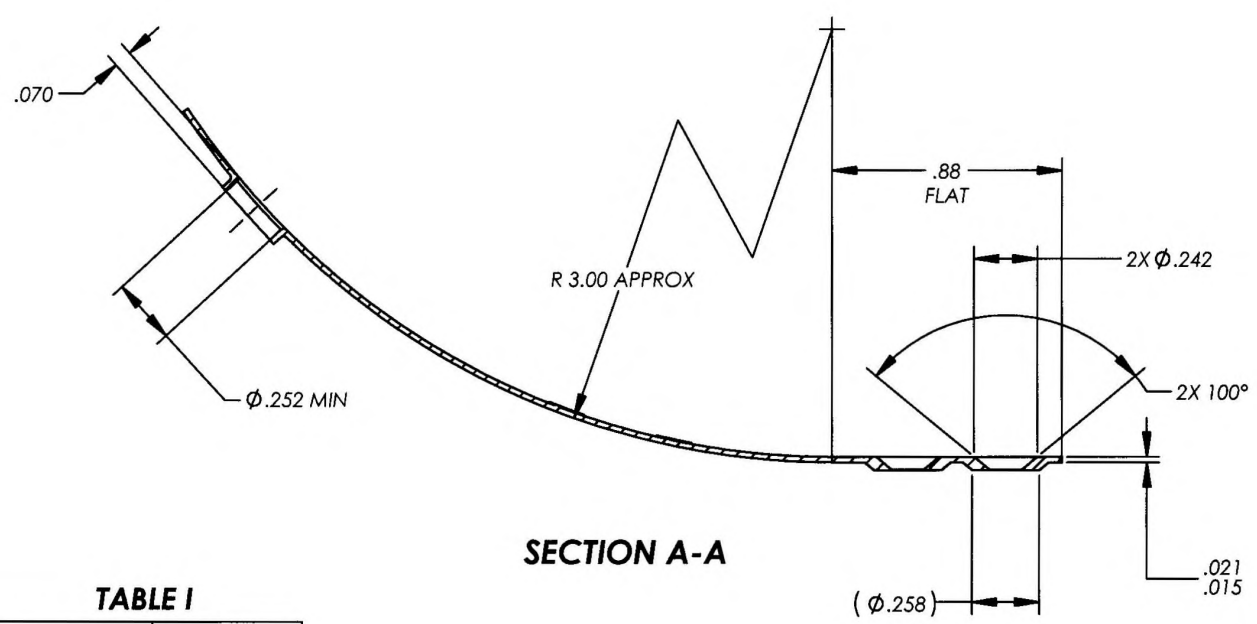

**TABLE I**

CATALOG PART NUMBER	DESCRIPTION
2600-ESD	AS SHOWN

- NOTES:** UNLESS OTHERWISE SPECIFIED
1. MATERIAL: SPRING STEEL.
  2. FINISH: CAD PLATE PER AMS-QQ-P-416 TYPE II, CLASS 2.
  3. HEAT TREAT: SPRING TEMPER.
  4. FOR INSTALLATION DATA REFER TO CAMLOC CATALOG.

INTERIM DOCUMENT REVISION		
Rev.	Date	DAF#
E1	10/8/2018	117431

APPROVED DATE 11/10/77	<b>ARCONIC</b> Arconic Fastening Systems	TITLE: <b>SPRING-EJECTOR, STUD,                  DIMPLED RIVET HOLES</b>	CURRENT DESIGN ACTIVITY: <b>7 1 2 8 6</b>
REV. LETTER AND DATE <b>E</b> 01/15/14	<b>CAMLOC PRODUCTS</b> 3012 W. LOMITA BLVD. TORRANCE, CA 90505-5103	UNLESS OTHERWISE SPECIFIED DIMENSIONS ARE IN INCHES & ASME Y14.5M TOLERANCES:	SALES DRAWING NO.  <b>2600-ESD</b>
DAF NUMBER 106620		ANGLES = ± 1° FRACTIONS = ± 1/32 DECIMALS .XX = ± .02 .XXX = ± .010	<b>SHEET 1 OF 1</b>